

ASSEMBLY HARDWARE

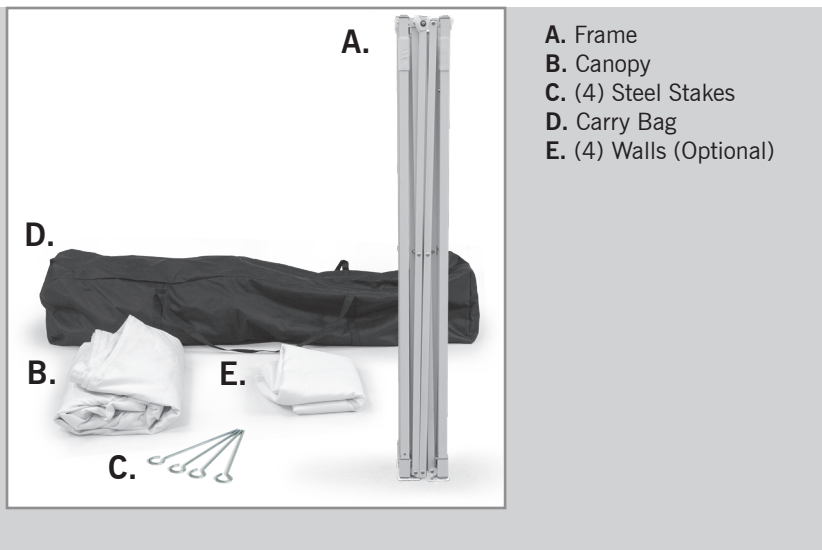

FRAME & CANOPY ASSEMBLY

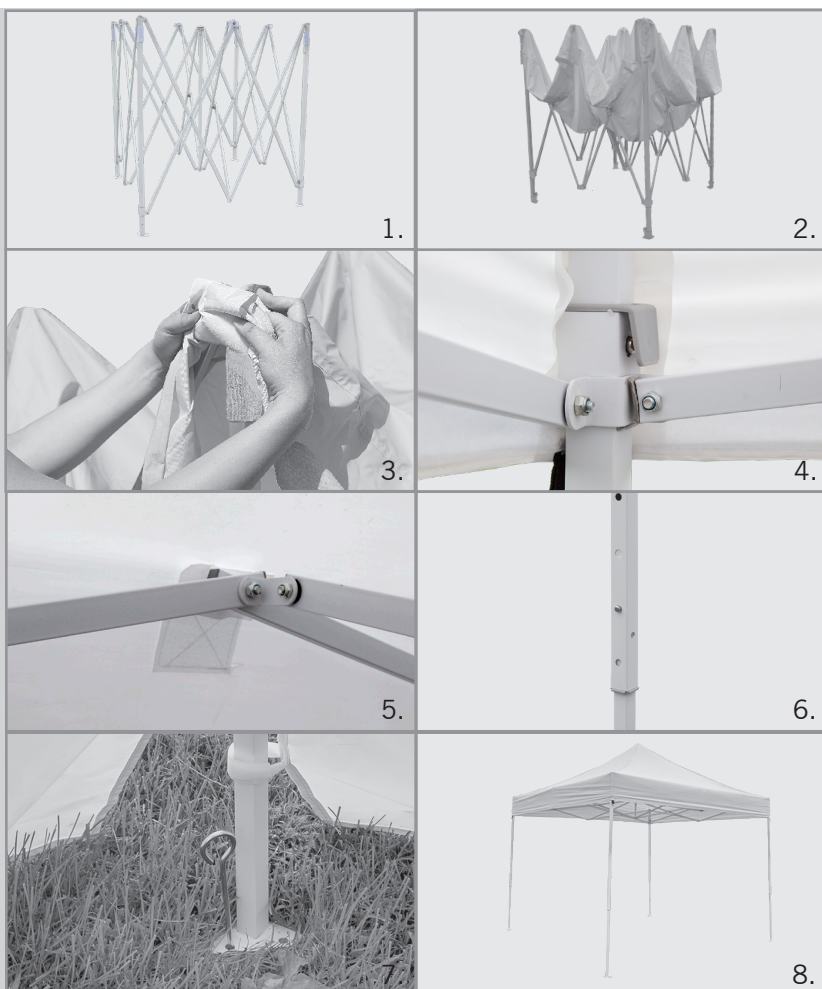

NOTE: It is recommended to use 2+ people for tent assembly.

1. Set the frame on the ground and expand approximately one third of the way outward.
2. Place the canopy over the frame. Make sure the corners of the canopy line up with the corners of the frame.
3. Attach the loop adhesive, located on the inside of the canopy, to the hook adhesive located around the top corners of the frame.
4. Completely expand the frame outward. The locking clips will snap into place to indicate full expansion of the frame.
5. Line up hook-and-loop fasteners on inside of the canopy with the frame to help keep canopy secure.
6. Pull up the legs of the frame to the desired height, making sure the locking clips snap into place.
7. If the tent is being used in grass or soil, use a rubber mallet to hammer the stakes through the holes in the feet to keep the frame secure.
8. Tent frame and canopy assembly is now complete.

NOTE: Remove canopy prior to collapsing and storing the frame. Do not store the frame with the canopy attached.

DISCLAIMER: Tents should always be staked down with Premium Tent Stake Kit and weighed down. Tents should not be used in inclement weather, including thunderstorms, heavy rains, lightning, and high winds. No grill or any type of open flame is to be used under or near the tent. User must read and observe assembly instructions. If this is not done correctly, it may result in damage to the unit, injury, or death, and all warranties will be void. All warranties will be void if hardware is used with any print not produced by us. Properly care for prints to keep them in great condition. Prints should never be dragged along the ground or stored without being properly folded and free from moisture. Make sure print is completely dried from any weather, and fold and store in a clean, dry place. We don't recommend storing print on frame.



WALL ASSEMBLY

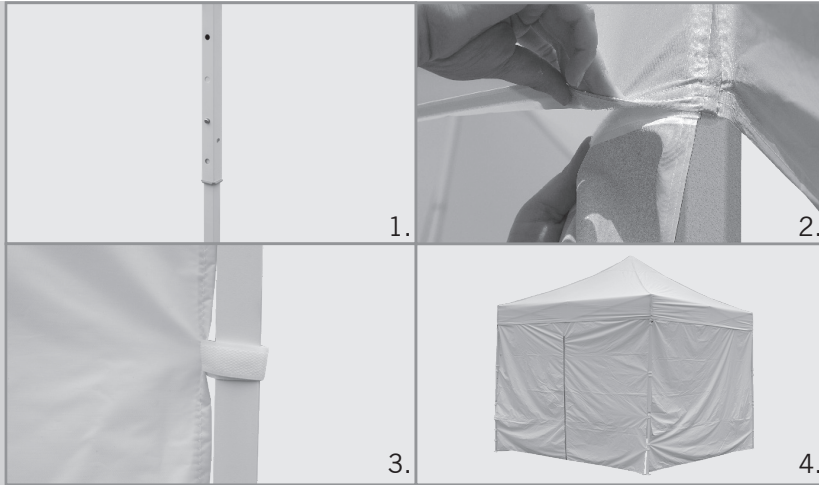

1. When adding tent wall(s), the legs of the frame must be at their maximum extension height.
2. Attach the wall's hook adhesive to the loop adhesive on the tent valance.
3. Secure the sides of the wall by wrapping the hook-and-loop adhesive tabs around the tent legs.
4. Wall assembly is now complete.

DISCLAIMER: Tents should always be staked down with Premium Tent Stake Kit and weighed down. Tents should not be used in inclement weather, including thunderstorms, heavy rains, lightning, and high winds. No grill or any type of open flame is to be used under or near the tent. User must read and observe assembly instructions. If this is not done correctly, it may result in damage to the unit, injury, or death, and all warranties will be void. All warranties will be void if hardware is used with any print not produced by us. Properly care for prints to keep them in great condition. Prints should never be dragged along the ground or stored without being properly folded and free from moisture. Make sure print is completely dried from any weather, and fold and store in a clean, dry place. We don't recommend storing print on frame.

